

EuroCave[®]

FIRST



USING
your wine cabinet

Contents

| | | |
|--|--|-------------------|
| | 1 - Your wine cabinet | p. 2-3 |
| | 2 - Important safety instructions | p. 4 |
| | 3 - Connecting to mains supply | p. 4 |
| | 4 - Installing your wine cabinet | p. 5 |
| | 5 - Putting into service - Temperature settings | p. 6-7 |
| | 6 - Changing the side on which the door opens | p. 8 |
| | 7 - Layout and storage | p. 9-10-11 |
| | 8 - Routine maintenance | p. 12 |
| | 9 - Operating problems | p. 13 |
| | 10 - Technical characteristics | p. 14 |

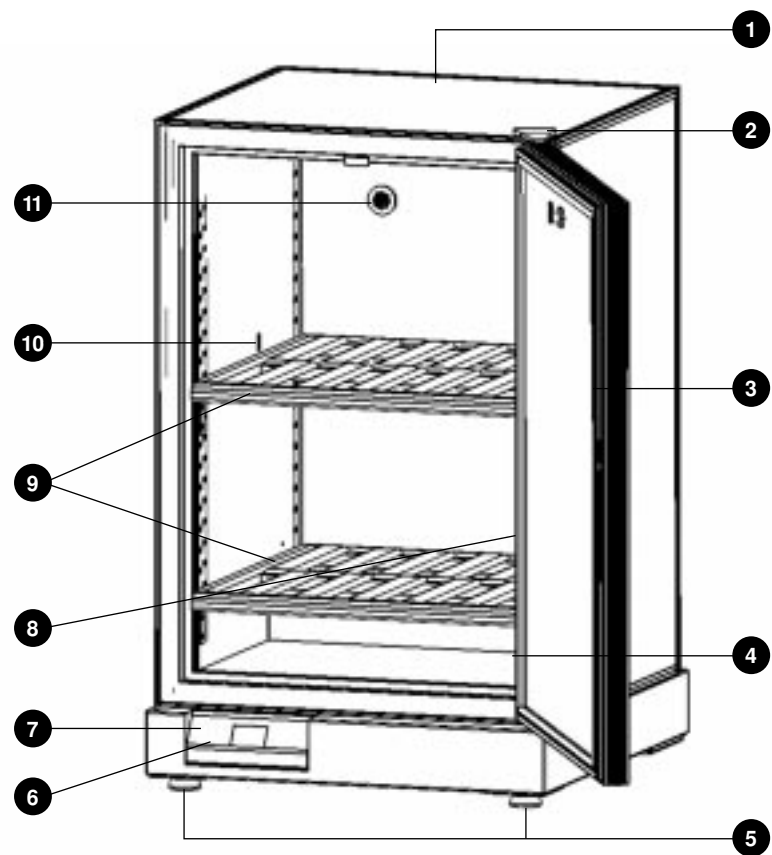

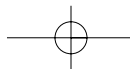

1 - Description of your wine cabinet

- 1** *Cabinet body*
- 2** *Hinge (with hinge plate cover)*
- 3** *Door*
- 4** *Label (lower right side in cabinet)*
- 5** *2 adjustable front feet*
- 6** *Temperature display and temperature adjustment control panel*
- 7** *Control panel protective cover*
- 8** *Hole*
- 9** *2 storage racks*
- 10** *Temperature sensor location*
- 11** *Hole + Active charcoal filter*

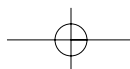
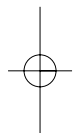



2 - Important safety instructions

PLEASE NOTE

You must always observe some basic precautions when using your wine cabinet, including:

Only use your wine cabinet for the use intended, as described in this guide.

Never unplug the wine cabinet by pulling on the power cord. Grip the plug firmly and pull straight out to remove from wall socket.

Immediately repair or replace any worn or damaged cord. Never use a cord that is split or which shows signs of wear along its length or on its ends.

Do not allow children to climb on, sit on or stand on the wine cabinet, nor hang from its shelves. They could damage the wine cabinet and injure themselves seriously.

Be sure always to keep your keys out of childrens' reach, to avoid them locking themselves in.



3 - Connecting to mains supply

FOR YOUR SAFETY, THE WINE CABINET MUST BE CORRECTLY EARTHED

The wine cabinet's power cord is equipped with a plug which fits into any standard socket with earth connection, to prevent any risk of shock.

Have the mains socket checked by a qualified electrician to make sure it is actually connected to earth.

If this is not the case, you must have it replaced with a socket which is suitably earthed.

If the power cord is damaged, have it replaced by a qualified electrician to prevent any risk.

If the wall socket is not equipped with an earth connection, it is your responsibility and your duty to have it replaced with a suitably earthed wall socket.

*If the plug does not match your socket, you may have another fitted. **PLEASE NOTE:** new electrical cables and plugs should be fitted by a qualified electrician.*

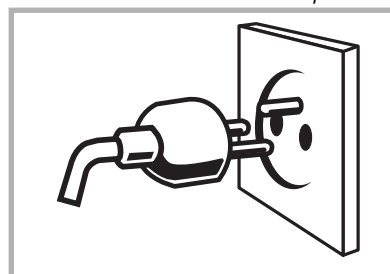

Make sure the socket is correctly earthed and that your installation is protection by a differential circuit-breaker.



4 - Installing your wine cabinet

- When unpacking your cabinet after delivery, make sure there are no visible external defects (i.e. signs of impact, deformation, etc.).
- Open the door and make sure that nothing is broken or missing (e.g. walls, shelves, hinges, control panel, etc.).
- Move your cabinet to your intended installation site. This location must:
 - not be in a confined space, to allow air to circulate (not in a closed cupboard, for example)
 - not be near any source of heat
 - not be too humid (e.g. laundry, linen, bathroom, etc.)
 - have a stable and flat floor
 - be equipped with a plug (for a standard 230V, 50/60 Hz, 16 A plug, with earth connection and differential circuit-breaker)
- Pull out the power cord so that it is accessible and position your cabinet while leaving 8 to 10 cm between its back and the wall.
- Adjust your cabinet's front feet (by screwing them in or out), until it is level (use of a spirit level is recommended).
- Remove the protective devices placed inside your cabinet.
- Take the charcoal filter you will find in the small bag of cabinet accessories, and fit it, from the inside of your cabinet, in the ventilation hole at the top on the left side.
- Arrange shelves according to your requirements (see section 7 of this guide)
- Before plugging in, allow the cabinet to sit for 48 hours, to allow fluids to settle.

NOTE: When moving your cabinet, never tilt it more than 45°, and always on the side of the power cord.

5 - Putting into service-Temperature settings



- **After waiting 48 hours, connect your cabinet to the mains socket** after making sure it is correctly supplied (check fuses and amperage and circuit-breaker). Connect another electrical device to check mains if necessary.
- Once your cabinet is plugged in, make sure the On-Off switch of the control panel is in the "On" position (I).

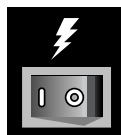

- If the switch is at the "On" position(see above diagram) when you connect your wine cabinet to the mains, the blue warning light only lights up if the ambient temperature is higher than 12°C.
(In the event of an anomaly, please refer to Chapter 9).

TEMPERATURE ADJUSTMENT

Note: setting the temperature of your wine cabinet is done solely from the control panel which is laid out in the following way.

| | |
|----------------------------|--|
| Temperature display panel: | Displays the effective temperature inside the wine cabinet |
| Adjustment dial: | Enables the setting of <u>required</u> temperature inside the wine cabinet |
| Circuit indicator lights | Enable you to see which circuit, hot (red) and cold (blue), is operating |
| TEST button: | Enables you to test your cabinet's circuits (see Chapter 9) |

N.B. For safety reasons, the control panel's protective transparent cover only opens (pivots towards the front) when the door of the cabinet is open.

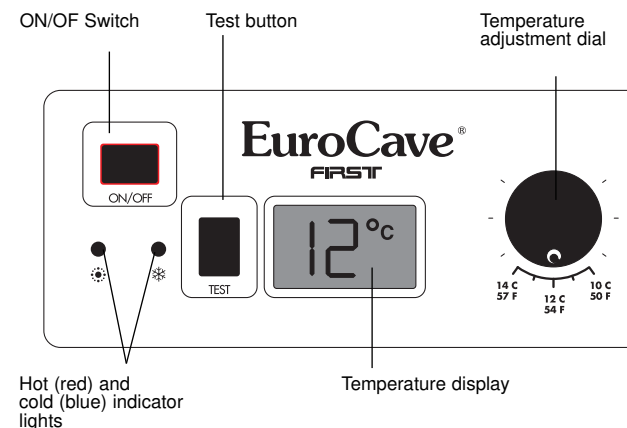

To set the temperature of your cabinet:

Turn the temperature setting dial until the mark  is on the interior temperature required.

WARNING: To operate correctly, your cabinet should be located in a room where the temperature range is between 0° and 35°C. If not, it will be difficult to obtain the temperature required.

Recommended setting range: 10° to 14°C.

It may be that despite following all the recommendations in this manual you cannot obtain the temperature you require. As each situation is unique, it is possible that it will be necessary to make some minor alterations to the recommendations.

To offer your wine ideal ageing conditions, your EuroCave wine cabinet is equipped with a safety thermostat that switches on if there is an excessive or unusual drop in temperature within (Temperature lower than 5°C).

6 - Changing the side on which the door opens



- Remove the hinge plate cover at the top of the cabinet, then unscrew the 3 star headed screws using a torque screwdriver size 25.

- Remove the upper hinge, then lift the door upwards.

- Unscrew, then remove the lower hinge pin (steel pin + washer)
- Place the hinge on the other side, taking care to replace the washer.

- Remove the 3 plastic grommets located on the top of the cabinet using a small lever (screwdriver).

- Replace the door onto the lower hinge.
- Replace the upper hinge.

- Replace the 3 star headed screws using a torque screwdriver in the following manner:

- 1 - Fully tighten screws Nos. 1 and 2.
- 2 - Carefully line up the door with the cabinet body.
- 3 - Tighten the last screw, No 3.

N.B. Line up the hinged side of the cabinet with the swivel pin side of the door frame. The gap between the door frame and the cabinet body should be approximately 10mm all the way around the cabinet. Check that the door is sealed.

- Replace the hinge plate cover.
- Replace the 3 plastic grommets in the right hand holes.

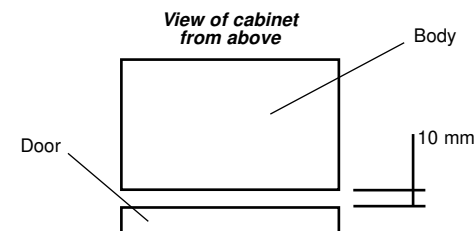
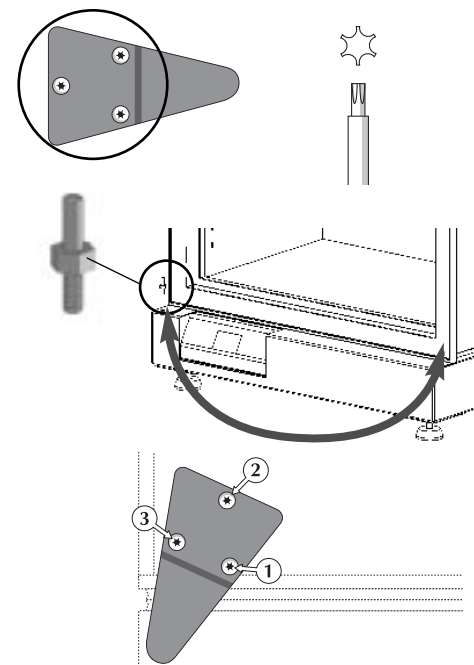



7 - Layout and Storage

Your EuroCave cabinet was **designed to evolve in time**. Delivered with 2 storage shelves, you may equip it with the various shelves in the "Classic" range, to best fit your storage requirements. Layout examples:

| Configuration | 1 storage shelf AXU 1 sliding shelf ABCU | 2 storage shelves AXU 1 sliding shelf ABCU | 1 storage shelves AXU 3 sliding shelves ABCU | 7 sliding shelves ABCU |
|---------------|---|---|---|------------------------|
| Capacity* | 96 bottles | 107 bottles | 109 bottles | 91 bottles |

* Bordeaux tradition type bottles.

VARIOUS TYPES OF STORAGE



Bordeaux bottle
storage shelf : **AXB**

Capacity: 78 bottles
Max. weight: 100 kg



Display kit: **AXK**

Capacity: 33 bottles
Max. weight:
inferior shelf 20 kg
superior shelf 10 kg



Bordeaux bottle
sliding shelf: **AXC**

Capacity: 13 bottles
Max. weight: 25 kg



Universal storage
shelf: **AXU**

Capacity: 77 bottles
Max. weight: 100 kg



Universal sliding shelf:
ABCU

Capacity: 12 bottles
Max. weight: 25 kg

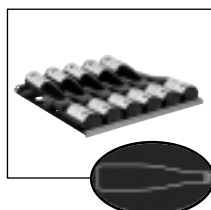

Alsace sliding
shelf: **ACR**

Capacity: 11 bottles
Max. weight: 25 kg

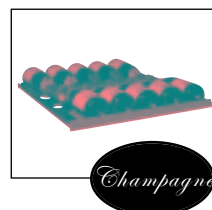

Champagne
sliding shelf
Ref.: **ACH**

Capacity: 10 bottles
Max. weight: 25Kg



Magnum sliding
shelf: **ACG**

Capacity: 7 bottles
Max. weight: 25 kg

Fitting shelf brackets (read carefully if you intend to modify your cabinet's shelf positions)

To move a storage shelf, first remove all bottles, then move the shelf brackets and make sure to fit them back into slots as shown below:

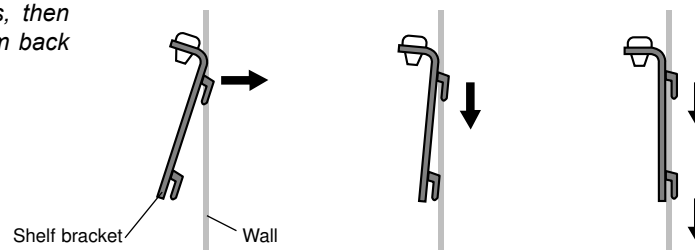

To move a sliding shelf, first remove all bottles, then remove the sliding tray by sliding it toward you while lifting the front part. Remove the sliding guides from the walls, while making sure not to mix up the right and left guides. Then refit them as shown below:

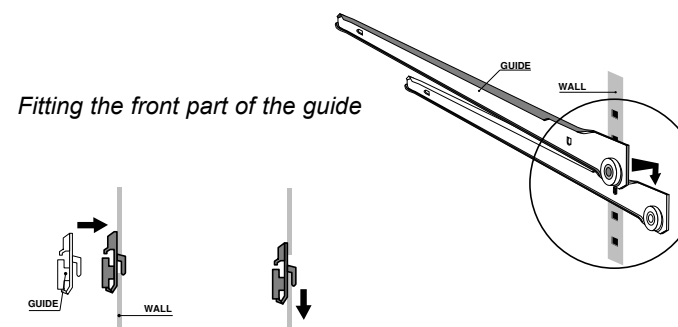
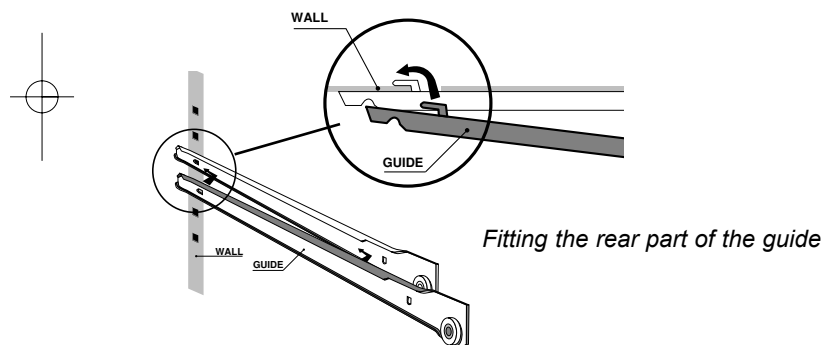

Then refit the sliding tray as shown below:

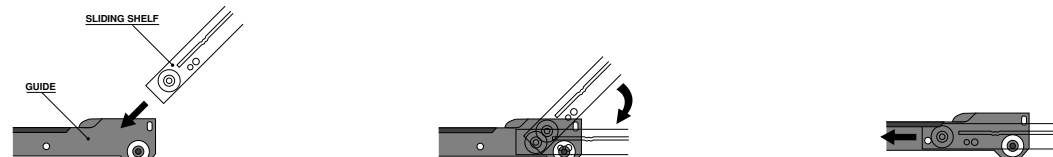

RECOMMENDATIONS FOR LAYOUT AND STORAGE YOUR WINE CABINET

Your EuroCave cabinet was designed to store a maximum number of bottles in total security. We recommend that you observe the tips below to optimize loading.

- Spread your bottles out as evenly as possible over the shelves, so that weight is not concentrated in one point. Also make sure your bottles do not touch the back of the cabinet, or the step at bottom.*
- Also make sure that bottles are not all grouped together at the top or bottom of the cabinet.*
- Observe the loading instructions provided in section 7, according to the type of storage fixtures with which your cabinet is equipped, and never stack bottles on a sliding shelf.*
- If your cabinet has sliding shelves, they should be installed toward the top of the cabinet to facilitate everyday access.*
- Also place one or two bottles of each of your wines on the sliding shelves and keep your reserve bottles on the storage shelves. Then simply replace bottles when necessary.*
- Never try to pull out more than one sliding shelf at a time.*

8 - Routine maintenance



Your Eurocave cabinet is easy to operate and has proven its reliability. It will provide long-lasting satisfaction if you follow the simple maintenance and cleaning operations listed below.

- Replace the activated charcoal filter in our cabinet's upper ventilation hole each year (your EuroCave distributor keeps this accessory in stock).
- Remove dust from the heat exchanger (metal screen on the back of the cabinet) twice a year.
- Make sure the power cord is unplugged before cleaning the back of your cabinet, or before moving it.
- Clean the inside of your cabinet thoroughly once a year, after unplugging and unloading it (use water and a mild cleaning product, then rinse carefully).
- Put the power switch on the "0" position, then unplug the cabinet before changing the temperature display battery(ies). Remove the display(s) through the front of the control panel, as shown below.

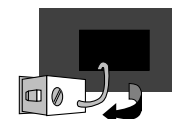

Use silver oxide SR 44W (357) battery

When the battery has been replaced, put the sensor wire back into the panel, and clip the display unit back in.

To assure that your wine cabinet provides long-lasting service, you should check it regularly and inform your dealer if you note anything unusual.

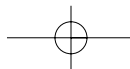

9 - Operating problems

START-UP

**Compressor does not start, even though the desired temperature is lower than the temperature in the room.
(Ambient temperature above 12°C)**

- 1-Check the wall socket by plugging in any type of electrical device, and make sure that the on/off switch is in the "I" position.
- 2-Press on the TEST button to check that both indicator lights (red and blue) light up..
- 3-Turn the temperature setting knob as far as it will go counter-clockwise, and make sure that the blue indicator light lights.
- 4-If the compressor still does not start after steps 2 and 3, contact your dealer.

Compressor does not stop.

- 1- Place your hand on the heat exchanger (metal screen at the back of your cabinet) to check its temperature. Contact your dealer if cold.
- 2-If the heat exchanger is hot, set the cold temperature as high as possible (as far as it will go clockwise) and make sure that the cold circuit operation indicator goes off. If the compressor does not stop, unplug the cabinet and contact your dealer.

DURING OPERATION

A liquid crystal display indicates a temperature below the temperature you set.

- 1 - Check the manual's recommended temperature settings (See page 7).
- 2-Check that the red hot circuit operation indicator light is on.
- 3-Press on the TEST button to check that both indicator lights (red and blue) are alight. If either step 2 or 3 is incorrect contact your dealer.

A liquid crystal display indicates a temperature above the temperature you set.

- 1-Check the temperature set-points (see pages 7 to 9 of this manual).
- 2-Check that the green cold circuit operation indicator light is on.
- 3-Press on the TEST button to check that both indicator lights (red and blue) are alight. If either step 2 or 3 is incorrect contact your dealer.

Contact your dealer, if after adjusting set-points and testing hot and cold circuit indicator lights either of the two problems above are not corrected.

Note: The refrigeration unit must only be serviced by a refrigeration technician, who must check the circuit for leaks before putting back into service. Any servicing of the electrical circuit must only be performed by an electrician.

NB: Whatever the case, if your cabinet does not seem to be operating normally, unplug it and call your dealer.

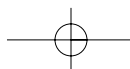

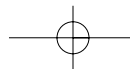

10 - Technical characteristics



Model n°
F120

| Dimensions (mm) | | | Weight in kg (empty) |
|-----------------|-----|-----|-------------------------|
| H | W | D | |
| 1050 | 654 | 689 | 44 |

| Electrical power | Max. current** | Consumption over 24 h | Voltage (V)* | Voltage tolerance | Frequency (Hz) * |
|---------------------|-------------------|--------------------------|-----------------|----------------------|---------------------|
| 110 W | 0,8 A | 0,7 kWh | 230 | +10/-10 | 50 |

| Gas |
|-------|
| R134A |

| Operating limits | |
|------------------|--------|
| Min. T | Max. T |
| 0°C | 35°C |

| Regulation precision |
|-------------------------|
| +/- 1,5°C |

| Display precision |
|----------------------|
| +/- 1°C |



* These values may vary according to country. Consult the identification label for your cabinet's specific characteristics (n°7 page 2).

** Current reaches a peak of about 5A when the compressor starts up.

These cabinets are **CE** certified

